



Stanley's demolition lineup is turning more than a few heads. Why? Because we make demolition tools that are more than just tough and strong. Our Wonder Bars® have been engineered to make pulling and prying easier. Our claw bars and nail pullers fit comfortably in the hand and have added length for better leverage. And new for this year, we're applying our patented AntiVibe® technology to our line of demolition hammers. We've invented a completely new type of tool in the industry, the FatMax® Xtreme™ Utility Bar, as well as a brand new line of cold chisels and punches.



FORGED FROM HIGH-GRADE STEEL FOR INCREASED STRENGTH AND DURABILITY

TEMPERED STRIKING FACE TO PREVENT CHIPPING

TWO-TIERED JAW FOR GRABBING COMMON DIMENSIONAL LUMBER AND DECKING

DEMOLITION TOOLS



Wonder Bar® Pry Bar



FatMax® Floor Chisel with Guard



FatMax® Wrecking Bar

BEVELED NAIL
FOR PULLING AND
PRying NAILS

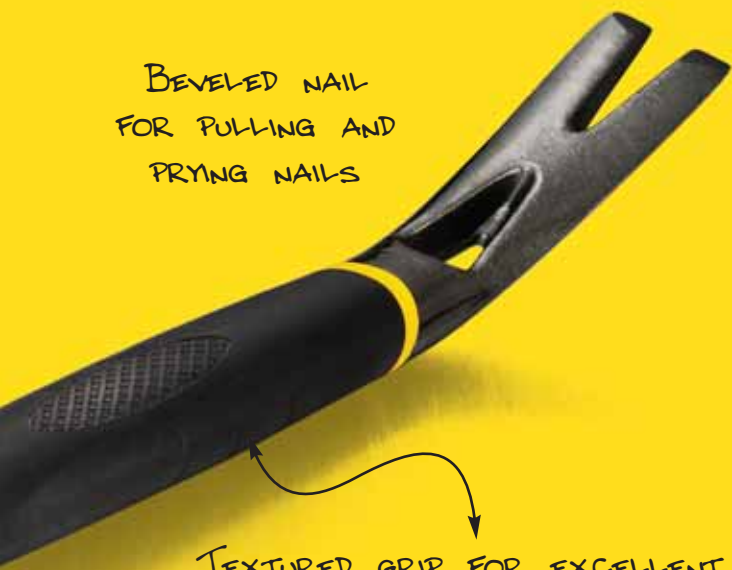

TEXTURED GRIP FOR EXCELLENT
COMFORT AND CONTROL EVEN
WHEN WET

STANLEY INNOVATION ADVANTAGE — BENDING STRENGTH

FatMax® demolition bars are engineered with the professional in mind. They are forged from high-carbon steel with a trilobe design that can withstand up to 975 foot-pounds of bending momentum.

DEMOLITION TOOLS

DEMOLITION SELECTION GUIDE



Demolition Tools

	DESCRIPTION	LENGTH
FatMax® Xtreme™ Fubar™	Utility Bar for heavy demolition work	18"
BoardBender Deck Tool	Straightens decking and joints	N/A
Wonder Bar® X21	For pulling nails, lifting or prying	21"
Super Wonder Bar®	Foot-levered, hands-free panel lift	15-1/2"
Wonder Bar®	Contoured bar makes pulling nails, prying and lifting easier	12-3/8"
Wonder Bar® II	Withstands bending moment of 310 in-lbs	7"
FatMax® Wrecking Bar	Withstands bending moment of 975 ft-lbs	14", 24", 36"
Combination Nail & Claw Chisel	Combination puller	15"
Offset Pattern Ripping Chisel	For heavy demolition work	17"
Forged Hexagonal Steel Ripping Bar	For heavy demolition work	17", 23", 29", 35"
Nail Claw	For nail pulling and prying	10"
Nail Puller	For nail pulling and prying	11"
Claw Bar	For precision nail pulling and prying	8", 10", 12"
Molding Bar	Flat surface allows for reduced damage while prying molding and trims	8", 10"
FatMax™ Demo Chisels	Ergonomic, bi-material handguard protects from overstrike	8-1/2", 12"
Cold Chisels/Brick Sets/Punches	One-piece construction forged from chrome vanadium steel for increased strength and durability. Hardened, quenched and tempered for long life and added safety. Powder coat finish for increased visibility	4", 12"



FatMax® Xtreme™ FuBar™ Utility Bar

- 4-in-1 tool for prying, splitting, board bending and striking jobs
- One piece forged steel bar for increased durability
- Two-tiered jaws for grabbing common dimensional lumber & decking
- Beveled nail slot for pulling & prying nails
- Textured grip for excellent comfort & control, even when wet
- Tempered steel that prevents chipping

Product SKU No.	O/A Length		Weight		Box/Ctn
	Inches	mm	oz.	grams	
55-099	18	457	64	1814	0 / 2



Wonder Bar® X21 Pry Bar

- Forged, high-carbon steel for increased strength and durability
- 21" long for better reach and greater leverage
- Excellent for pulling nails, lifting or prying
- High-visibility, powder-coated finish

Product SKU No.	O/A Length		Blade Width		Box/Ctn
	Inches	mm	Inches	mm	
55-526	21	533	1.75	44	0 / 4



Super Wonder Bar® Pry Bar

- Forged, high-carbon steel for increased strength and durability
- Heat-treated for increased durability
- Polished and beveled cutting edges
- Patented, arched center gives more swing during nail pulling – no need for a wood block
- Tight radius on bend angle aids in positioning bar
- Extended tongue improves grip and reach in hard-to-get-at places
- Excellent for use as a foot-levered, hands-free panel lift
- High-Visibility, powder-coated finish

Product SKU No.	O/A Length		Blade Width		Box/Ctn
	Inches	mm	Inches	mm	
55-525	15-1/2	395	1-3/4	44	0 / 4



Wonder Bar® Pry Bar

- Forged, high-carbon steel for increased strength and durability
- Heat-treated for increased durability
- Polished and beveled cutting edges
- Contoured bar makes pulling nails, prying, lifting and scraping easier
- Beveled nail slot at both ends
- High-Visibility, powder-coated finish

Product SKU No.	O/A Length		Blade Width		Box/Ctn
	Inches	mm	Inches	mm	
55-515	12-3/8	314	1-3/4	44	4 / 24

Wonder Bar® II Pry Bar

- Heat treated for increased durability
- Tempered steel able to withstand a bending momentum of 310 in-lbs.
- High-visibility, powder-coated finish

Product SKU No.	O/A Length		Blade Width		Box/Ctn
	Inches	mm	Inches	mm	
55-045	7	180	7/8	22	6 / 36



FatMax® Wrecking Bar

- Forged, high-carbon steel able to withstand 975 ft-lbs. of bending momentum
- Tri-lobe design increases strength, durability and ease of use
- High-visibility, powder-coated finish
- Slotted claw and beveled ends improve functionality and performance

Product SKU No.	O/A Length		Blade Width		Box/Ctn
	Inches	mm	Inches	mm	
55-101	14	356	1	25	0 / 4
55-102	24	610	1.5	38	0 / 4
55-104	36	914	1.5	38	0 / 4



Offset Pattern Ripping Chisel

- Extra wide claw
- Beveled nail slot

Product SKU No.	O/A Length		Stock Size		Cutting Edge		Box/Ctn
	Inches	mm	Inches	mm	Inches	mm	
55-818	17	432	11/16	17	1-11/16	43	0 / 5



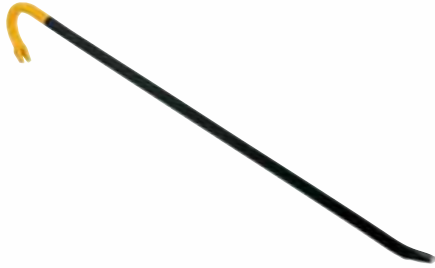

Forged Hexagonal Steel Ripping Bar

- High-carbon steel adds prying strength
- Chisel end is beveled
- Both slotted claw and chisel ends are polished

Product SKU No.	Size		Box/Ctn
	Inches	mm	
55-118	5/8 x 18	16 x 455	0 / 6
55-124	3/4 x 24	19 x 610	0 / 6
55-130	3/4 x 30	19 x 760	0 / 6
55-136	3/4 x 36	19 x 915	0 / 6



Nail Claw

- Special extracting claw
- Heat treated for durability
- Beveled nail slot

Product SKU No.	O/A Length		Stock Size		Box/Ctn
	Inches	mm	Inches	mm	
55-033	10	254	9/16	14	0 / 6



Nail Puller

- Double-end puller features 90° and 30° offset claws
- Fully sharpened claw tips
- Heat-treated for durability

Product SKU No.	O/A Length		Stock Size		Box/Ctn
	Inches	mm	Inches	mm	
55-035	11	280	5/8	16	0 / 5

Claw Bar

- Flat striking face allows claw to be driven under deeply embedded nails
- Forged, high-carbon alloy steel for long life
- Tempered for safety and heat treated for durability
- Polished, beveled claws allow for precision nail pulling and prying

Product SKU No.	O/A Length		Blade Width		Box/Ctn
	Inches	mm	Inches	mm	
55-113	8	203	N/A	N/A	2 / 6
55-114	10	254	N/A	N/A	2 / 6
55-115	12	305	N/A	N/A	2 / 6



Molding Bar

- Flat surface allows users to cleanly pry molding and trim reducing material damage
- Forged high-carbon alloy steel for long life
- Tempered for safety and heat treated for durability
- Polished, beveled claws allow precision nail pulling and prying

Product SKU No.	O/A Length		Blade Width		Box/Ctn
	Inches	mm	Inches	mm	
55-116	8	203	1.75	44	2 / 6
55-117	10	254	1.75	44	2 / 6



Board Bender Deck Tool

- Straightens decking and joists with ease
- Extra heavy duty, 5/8" high-carbon steel bar
- Cushioned handle designed for kneeling to maintain pressure
- Frees both hands for nailing
- Saves time, money and materials

Product SKU No.	Box/Ctn
93-310	0 / 2

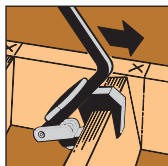

STRAIGHTEN JOISTS.

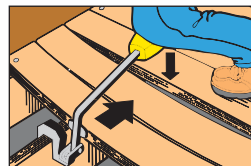

HOOK TOOL ON JOIST.
PUSH HANDLE DOWN.
BOARDS SQUEEZE TIGHT.



FatMax™ Cold Chisels

- Ergonomic, bi-material handguard protects from overstrike
- One-piece construction forged from chrome vanadium steel for increased strength and durability
- Hardened, quenched and tempered for long life and added safety
- Powder coat finish for increased visibility



FatMax™ Cold Chisel with Bi-Material Hand Guard

- For Cutting / Shaping Wrought Iron, Cast Iron, Steel, Brass, Bronze, Copper, Aluminum, Bolts, Nuts & Rivets

Product SKU No.	Description	Box/Ctn
16-332	Cold Chisel - 1" X 12" W/Guard	3 / 18



FatMax™ Brick Sets with Bi-Material Hand Guard

- For cutting and splitting brick and masonry

Product SKU No.	Description	Box/Ctn
16-327	Brick Set - 3" X 8-1/2" W/Guard	3 / 18
16-328	Brick Set - 4" X 8-1/2" W/Guard	3 / 18



FatMax™ Concrete Chisel with Bi-Material Hand Guard

- Durable bull point that cuts fast, and lasts long. Ideal for cutting through and breaking up concrete

Product SKU No.	Description	Box/Ctn
16-329	Concrete Chisel - 3/4" X 12" W/Guard	3 / 18

FatMax™ Electrician's Chisel with Bi-Material Hand Guard

- For rough cutting and trimming of wood, wallboard, and masonry

Product SKU No.	Description	Box/Ctn
16-330	Electrician's Chisel - 2-1/4" X 10" W/Guard	3 / 18



FatMax™ Floor Chisel with Bi-Material Hand Guard

- Used for cutting, prying or ripping of hardwood flooring and nails
- Designed with offset blade and shorter bite for increased leverage

Product SKU No.	Description	Box/Ctn
16-331	Floor Chisel - 3" X 11" W/Guard	3 / 18



FatMax™ Mason's Chisels with Bi-Material Hand Guard

- Used for cutting and splitting hard stone, brick, and concrete

Product SKU No.	Description	Box/Ctn
16-333	Mason's Chisel - 1-3/4" X 8-1/2" W/Guard	3 / 18
16-334	Mason's Chisel - 2-3/4" X 8-1/2" W/Guard	3 / 18



Stanley® Cold Chisels

- One-piece construction forged from chrome vanadium steel for increased strength and durability
- Hardened, quenched and tempered for long life and added safety
- Powder coat finish for increased visibility



Cold Chisels

- For Cutting / Shaping Wrought Iron, Cast Iron, Steel, Brass, Bronze, Copper, Aluminum, Bolts, Nuts & Rivets

Product SKU No.	Description	Box/Ctn
16-286	Cold Chisel - 3/8" X 5-9/16"	3 / 24
16-287	Cold Chisel - 1/2" X 6"	3 / 24
16-288	Cold Chisel - 5/8" X 6-3/4"	3 / 24
16-289	Cold Chisel - 3/4" X 6-7/8"	3 / 24
16-290	Cold Chisel - 7/8" X 8"	3 / 24
16-291	Cold Chisel - 1" X 12"	3 / 24
16-292	Cold Utility Chisel - 1-1/4" X 12" Flat	3 / 24



Brick Sets

- Used for cutting and splitting brick and concrete

Product SKU No.	Description	Box/Ctn
16-296	Brick Set - 3" X 8.5"	3 / 24
16-297	Brick Set - 4" X 8.5"	3 / 24



Floor Chisel

- Used for cutting, prying or ripping of hardwood flooring and nails
- Designed with offset blade and shorter bite for increased leverage

Product SKU No.	Description	Box/Ctn
16-293	Floor Chisel - 3" X 11"	3 / 24



Mason's Chisels

- Used for cutting and splitting hard stone, brick, and concrete

Product SKU No.	Description	Box/Ctn
16-294	Mason's Chisel - 1-3/4" X 8-1/2"	3 / 24
16-295	Mason's Chisel - 2-3/4" X 8-1/2"	3 / 24

Center Punches

- Used for marking metal or making indentations for starting drill holes
- One-piece construction forged from tempered tool steel for strength
- Hardened and tempered for long life

Product SKU No.	Description	Box/Ctn
16-227	Center Punch - 1/4" X 4"	3 / 24
16-228	Center Punch - 5/16" X 4-1/2"	3 / 24



Starter Punch

- Used for starting drill holes
- One-piece construction forged from tempered tool steel for strength
- Hardened and tempered for long life
- Powder coat finish for increased visibility

Product SKU No.	Description	Box/Ctn
16-229	Starter Punch - 3/32" X 5-1/2"	3 / 24



Pin Punches

- One-piece construction forged from tempered tool steel for strength
- Hardened and tempered for long life
- Powder coat finish for increased visibility

Product SKU No.	Description	Box/Ctn
16-230	Pin Punch - 1/16" X 6"	3 / 24
16-231	Pin Punch - 1/8" X 6"	3 / 24
16-232	Pin Punch - 5/32" X 6"	3 / 24
16-233	Pin Punch - 3/16" X 6"	3 / 24
16-234	Pin Punch - 1/4" X 6"	3 / 24
16-235	Pin Punch - 5/16" X 6"	3 / 24



Prick Punch

- Used for marking metal
- One-piece construction forged from tempered tool steel for strength
- Hardened and tempered for long life
- Powder coat finish for increased visibility

Product SKU No.	Description	Box/Ctn
16-236	Prick Punch - 3/8" X 5-1/2"	3 / 24



Cold Chisel and Punch Kits

- Available as 12-piece punch and chisel kit, 3pc chisel set, and a 6-piece punch kit
- Accessible packaging enables customer to easily evaluate products in store

Product SKU No.	Description	Box/Ctn
16-226	Punch Kit - 6 pc	3 / 24
16-298	3 Pc. Cold Chisel Kit	3 / 24
16-299	12 Pc. Punch & Chisel Kit	3 / 12



16-299